

Event Traffic Marshals: Information for Traffic Management Designers

1 Background

This fact sheet has been developed to inform Traffic Management Designers (TMDs) about the requirements when planning and designing traffic management arrangements for Special Events where [Event Traffic Marshals \(ETMs\)](#) will be engaged.

Event Traffic Marshals...

- ETMs are event volunteers who are authorised to undertake basic STOP / SLOW traffic control duties in simple, low-risk traffic environments for the duration of a permitted Special Event.
- ETMs may install official traffic signs if specified on the event Traffic Guidance Scheme (TGS). Generally, this should be limited to the 'Traffic Controller Ahead / PREPARE TO STOP' sign.
- An accredited Traffic Controller may substitute for an ETM at any ETM traffic control stations denoted on the TGS, but not vice versa.
- ETMs **shall not** control reversible flow arrangements (commonly known as shuttle flow).
- ETMs **shall not** be used for roadworks or workplaces.

2 Designing a Traffic Guidance Scheme using Event Traffic Marshals

Changes to the Transport Operations (Road Use Management – Accreditation and Other Provisions) Regulation 2015 allow Event Organisers to engage ETMs to undertake limited traffic control duties in low-risk environments, where specified on the approved Traffic Guidance Scheme (TGS) for the event. TMDs, therefore, play a vital role in the evaluation of risks and determining whether event locations and arrangements are suitable for ETM use. As with the development of all Traffic Management Plans (TMPs) and TGSs, the TMD should consider risk (refer to [Queensland Guide to Temporary Traffic Management](#) (QGTTM) and to the [Event Traffic Management Design Guidelines](#) (ETDMG). TMDs should document all assumptions and assessments of risk when considering whether to specify the use of ETMs as part of a TGS. If the road environment is assessed as being more complex, then traffic control shall only be undertaken by [accredited Traffic Controllers](#) or Police Officers.

Table 2 – Risk factors for Event Traffic Marshal deployment

Road risk attributes for situations where Event Traffic Marshals can be deployed	Additional factors that should be considered when determining if an environment is low risk
<ul style="list-style-type: none"> • Speed limit or speed environment of 60 km/h or less • Highest volume while the event is in progress: 200 vehicles / hour • Road type: two-way two-lane or one-way one-lane • Available sight distance • Road geometry • Timing of event • Volume and type of heavy vehicles 	<ul style="list-style-type: none"> • Not at a signalised intersection • Not at an at-grade railway crossing • Number of event participants or spectators • Crash history

Refer to ETDMG for more information on road risk attributes for situations where ETMs can be deployed and additional factors that should be considered when determining if an environment is low risk.

3 Traffic Management Design for Event Traffic Marshals

When preparing a TGS that incorporates ETMs, TMDs should clearly differentiate and label ETM and accredited Traffic Controller positions. The TGS shall include instructions that specify the activities each ETM is expected to undertake, including the signs that the ETM is expected to install.

The 'Traffic Controller Ahead / PREPARE TO STOP' sign shall be placed as per the requirements of the QGTTM Part 3 Section 4.8 in advance of any location where ETMs are undertaking traffic control. The use of four cones on the centreline as per the QGTTM Part 3 Section 4.8 is intended for reversible flow arrangements only and therefore not applicable to ETMs.

Figure 3 – Example Traffic Guidance Scheme arrangements for a special event

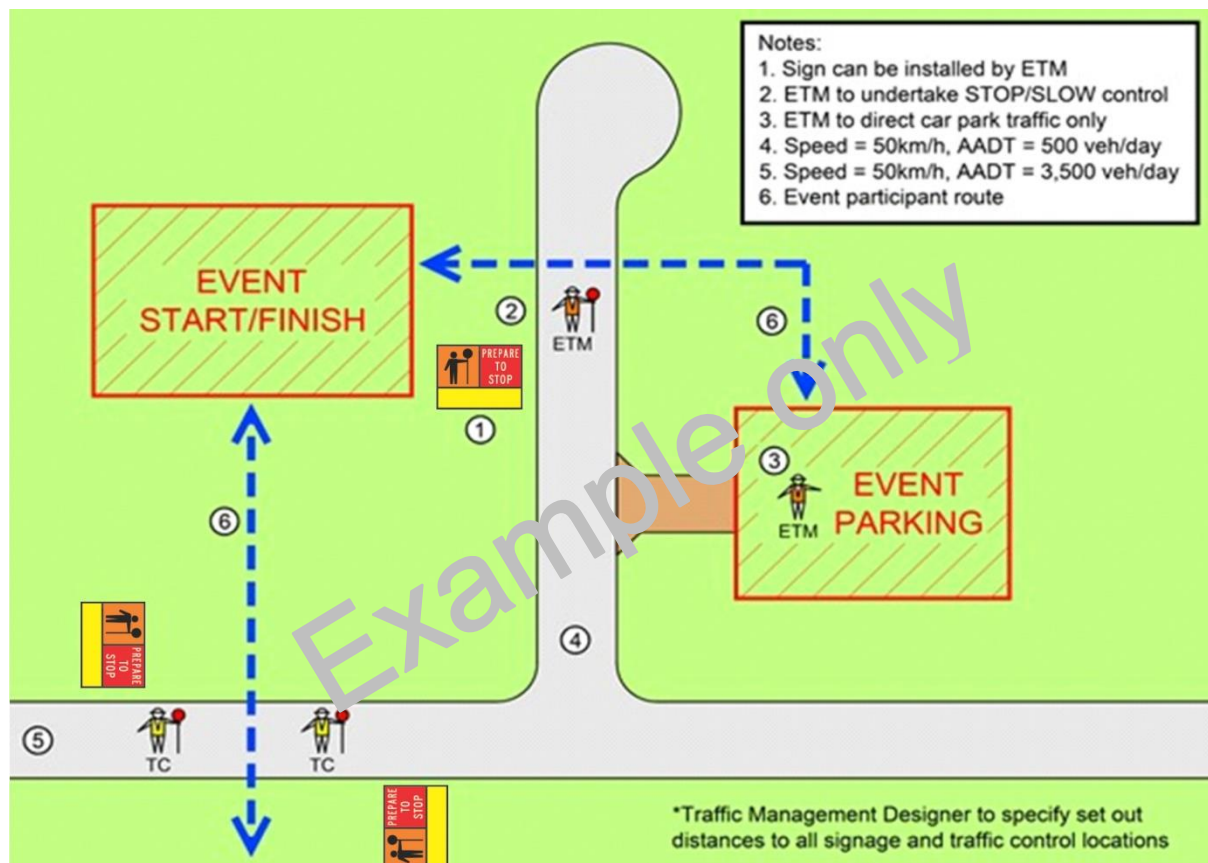

This figure is indicative and provided as an example only. TGS design shall be undertaken in accordance with the requirements of the QGTTM, Queensland MUTCD Part 3 and the ETMDG.

In all cases, the TGS must be prepared by a TMD who is a competent person as per the requirements of the QGTTM.

4 Additional resources

- [Queensland Guide to Traffic Management Part 9 Transport Control Systems – Strategies and Operations Section 5.2 Planned and special event management](#)
- [Queensland Government Events in Queensland – Best practice guidelines for event delivery in Queensland](#)
- [Traffic management at special events](#)

- [Event Traffic Marshal Scheme](#)
- [Queensland Guide to Temporary Traffic Management](#) (QGTMM)
- Queensland [Manual of Uniform Traffic Control Devices](#) (MUTCD)
- [Event Traffic Management Design Guideline](#) (ETMDG)
- [MUTCD Q-series and Traffic Control \(TC\) signs](#)
- [Temporary Traffic Management](#).

5 For more information

For more in-depth information about traffic control signage, devices and standards, contact trafficengineering.support@tmr.qld.gov.au.

